

### HILL TOWN A WORLD OF ITS OWN

Experience expansive mountains, nature, clean air and greenery at your very own home at Hill Town, giving a whole new dimension to luxury living with this one-of-a-kind project. As Hill Town space abounds everywhere, and the super-sized rooms with well-appointed windows provide uninterrupted views of the spectacular Aravalli range. From independent villas & plots, to premium residential housing for the social ones or independent floors for those who value their privacy over anything else, we have something for all. Living at Hill Town, has its own share of perks. A lifestyle that resembles a resort, retail & commercial establishments, security of a gated community and the camaraderie of the like-minded. Welcome to your new life!



### WORLD CLASS CLUBHOUSE AND RECREATIONAL FACILITIES

Magnificent living requires magnificent gestures. The clubhouse at Hill town stands as a testament to this statement, offering both the sports enthusiasts and the leisure seekers the avenues to pursue their interests with equal passion. With a focus to provide you with a green and serene lifestyle, everything here is imbued with a green approach ensuring a well balanced lifestyle for you and your family. Mini theatre, cafeterias, library cum reading lounge, swimming pool with a separate kids pool & a world class, well-equipped gymnasium are just a few things that will keep you engrossed and at the same time, in the pink of health. Thereby keeping to our promise of a life replete with fun and bliss.



Mini theatre | World class gymnasium | Badminton courts | Tennis courts | Squash courts | Reading lounge cum library | Spa & massage | Yoga & meditation pavilion | Cafeteria | Multi-purpose party arena | Kid's play area | Indoor games area with snooker, table tennis & much more

### IF THE ABOVE WEREN'T ENOUGH, WE THOUGHT OF ADDING A FEW MORE

Golf putting | Elder's corner | Organic farming | Rock climbing | Jogging tracks | Cycling tracks | Cricket pitches | Landscaped gardens



A premium Hill View residence is your home in the lap of nature. A part of the lush 140 acre development, these residences are the perfect ode to nature inspired living. With the majestic hills greeting you each morning to mesmerizing sun sets, your charmed life begins here with peace and tranquility unlike any other. Come, indulge in something never heard of.

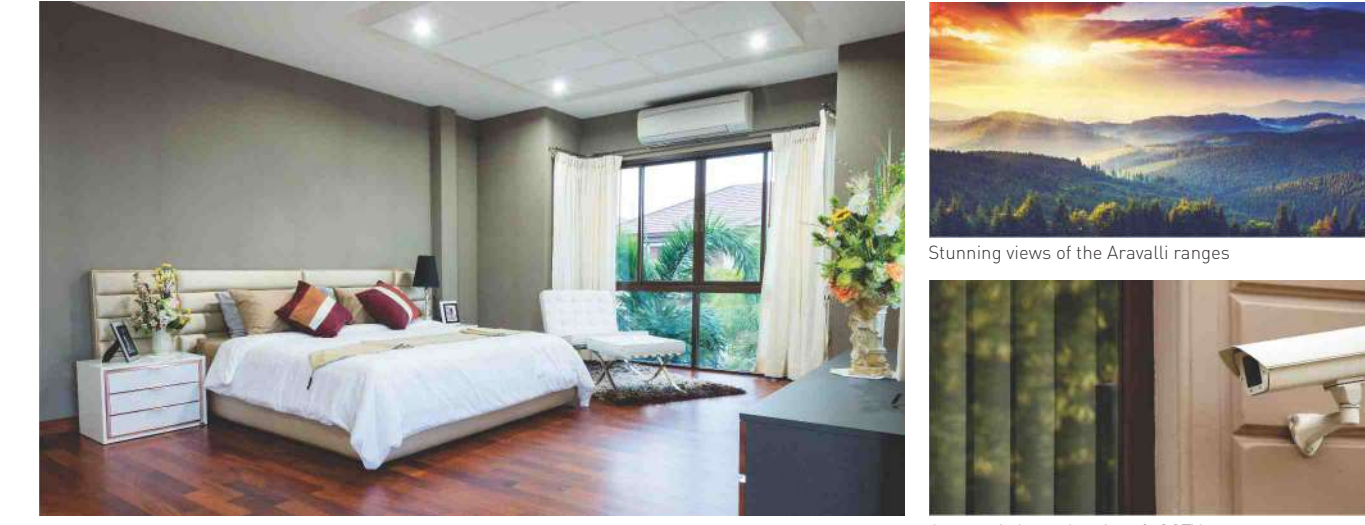

Structure	Earthquake resistant, RCC framed structure with external brick / block walls
Living / Dining Room / Drawing Room	Floor: Marble / Spanish designer Vitrified Tiles
	Walls: Cement plaster with POP painting with plastic emulsion paint or feature finish.
	Ceiling: Gypsum with Design Elements
Master / Bedroom	Floor: Ceramic Tiles (Bathroom - Ceramic Tiles)
	Walls: Cement plaster with POP painting with plastic emulsion paint or feature finish.
	Windows: Multiple Aluminium / Customized Gypsum with Design Elements
Other bedroom(s)	Floor: Marble Tiles / Wooden Laminate Flooring
	Walls: Cement plaster with POP painting with plastic emulsion paint.
	Ceiling: Gypsum
Servant / Utility Rooms	Floor: Ceramic Tiles / Red floor with ceramic tiles
	Walls: Cement plaster with GSD
	Ceiling: Gypsum
Dwars	Entrance doors: Elegantly designed 8 ft. high entrance door with polished hardwood frame having European style moulded profile with high quality import/modern hardware fittings.
	Internal doors: Seasoned wooden frame with European style moulded door style.
	External doors: Aluminium / UPVC / Glass doors

Washroom	Walls	Spanish Tiles in walls till ceiling height for master washroom, all other washrooms will have wall tiles upto 7ft. In. balance painted in acrylic emulsion paint.
Washroom	Floor	Marble / Spanish vitrified tiles or equivalent flooring for master toilet, all other washroom will have ceramic tiles.
	Windows	Premium Quality WC and washbasin in washrooms, Medication, Single lever C.P fittings, Toilet paper or equivalent. All the washrooms will have shower bar, mirror, toilet rack, rod & ring accessories. For specially designed Master Washroom, outside bath, mirror with well-measured vanity lighting & glass.
	Ceiling	GSD / False Ceiling
Kitchen	Walls	Ceramic Tiles in kitchen
	Floor	Vitrified Tiles
	Countertop	Marble / Granite top
Bathroom	Floor	Fittings of tub or equivalent. Shower head, stainless steel with drain board.
	Walls & ceiling	Gypsum with Design Elements
	Windows	Acrylic emergency / External Viewing Panels
Lift Lobbies / Corridors	Floor	Ceramic Tiles / Marble Tiles
	Walls	Marble Tiles / Ceramic Tiles
	Windows	Acrylic emergency / External Viewing Panels
Staircase	Flooring	Marble / Granite flooring
	Walls	Ceramic Tiles / Marble Tiles
	Windows	Acrylic emergency / External Viewing Panels
Site	Entrance	Heavy duty profiled steel in parking area
	Walls	Cement plaster
	Ceiling	Gypsum
Facilities	Communication	TV Cable for all rooms
	Power Back-up	100% power back-up essential services and apartments
	Electrical Fixture	Modern ring certified switches fitted and equipped IPMCB, copper wiring Two wall light fixtures in each of living, dining / lobby and bedrooms
General	Elevator	Branded lifts
	Security Systems	Secured gated community with access control at entrance with Automatic boom barriers and manual gates at entry and exit of the development. CCTV in basements, ground floor lobbies and main entrance lobby for surveillance. IPMS system fitted to each unit.

### ARTISTIC IMPRESSION



### TYPICAL UNIT PLANS

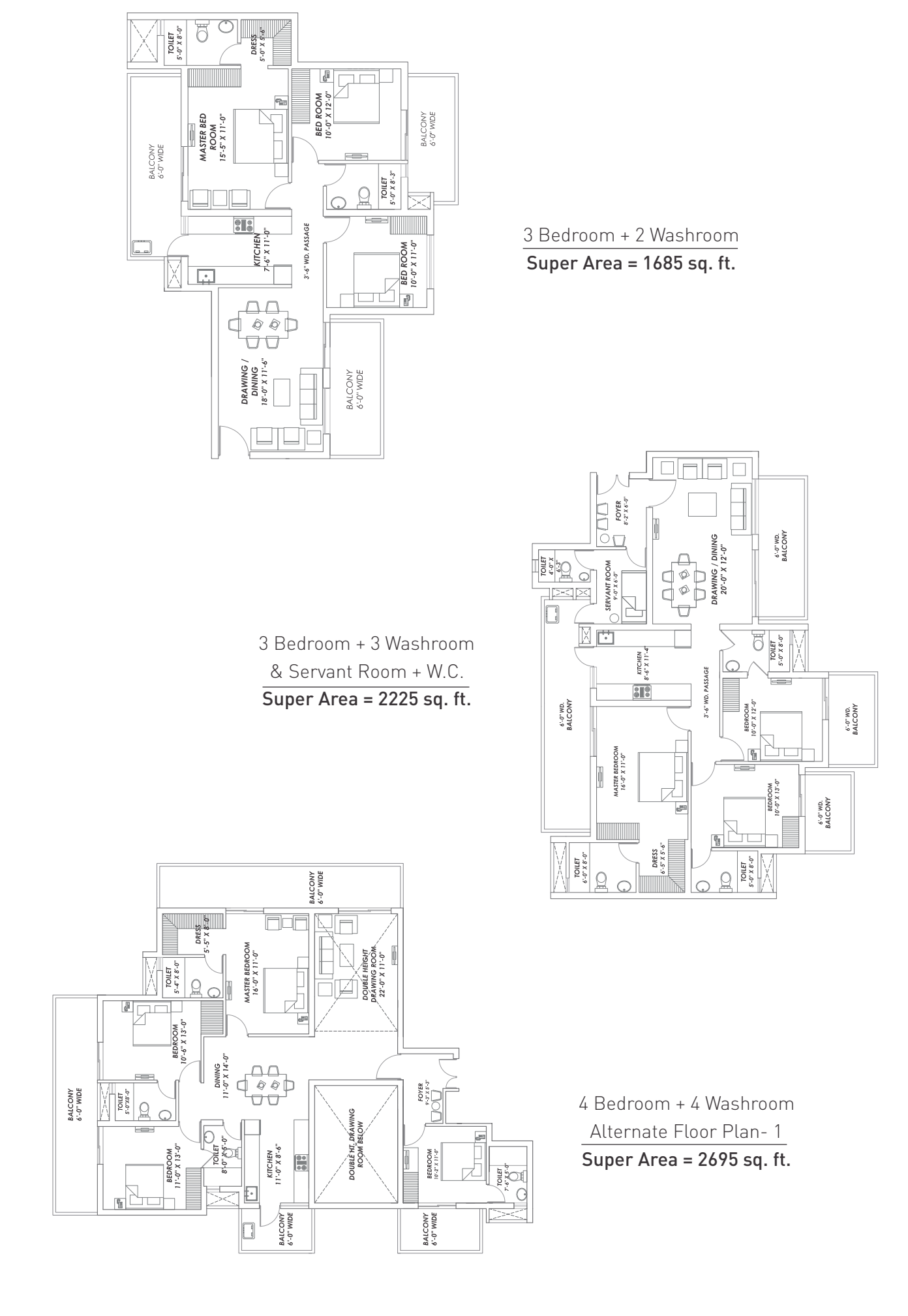
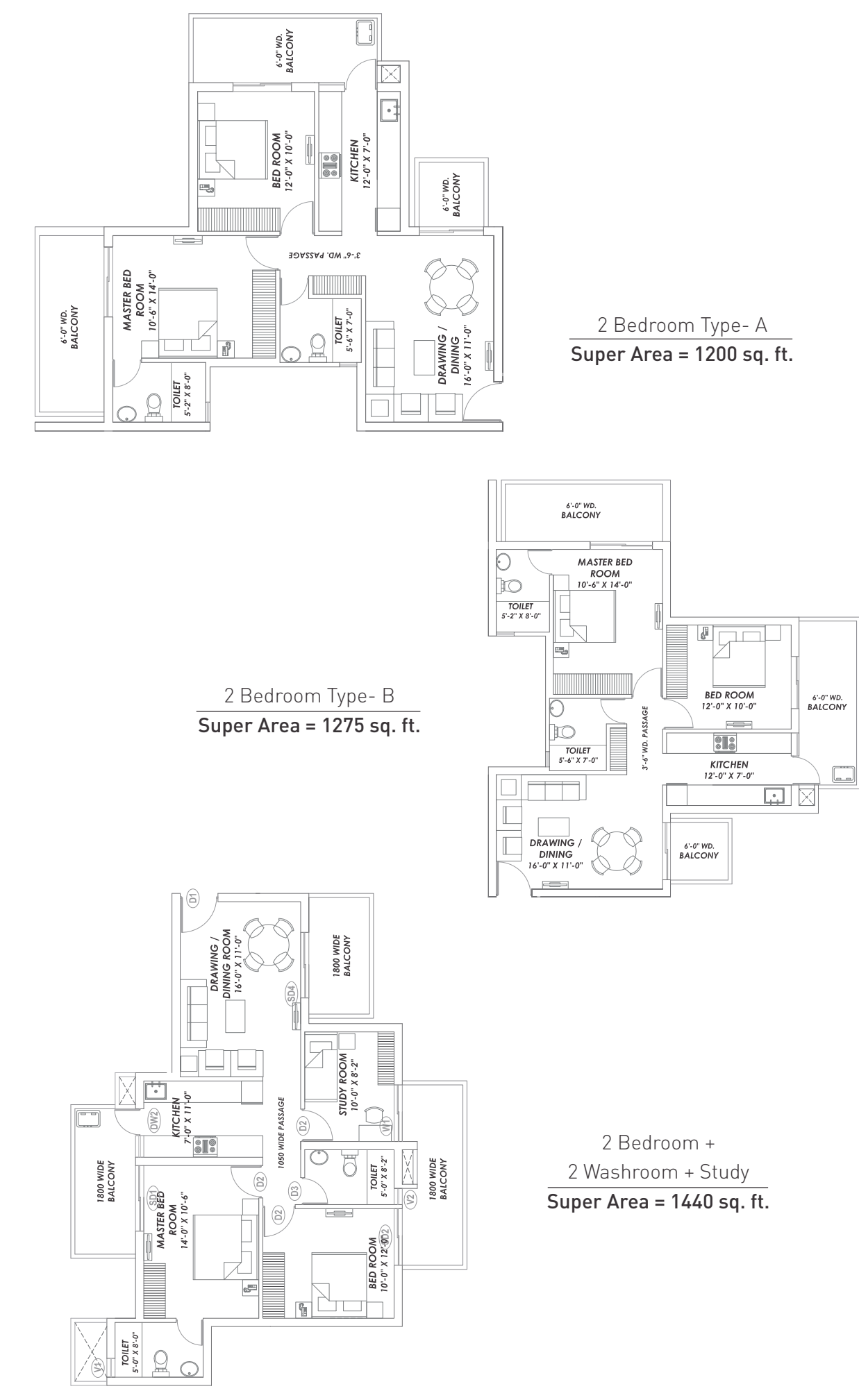

### ABOUT US

Supertech Ltd. - one of India's leading real estate developers came into inception close to 25 years ago. The company has been instrumental in redefining home buying for any customer around the country. With more than 60,000 satisfied customers & more than 20,000 residences delivered, the company is scaling new heights each day with more than 36 ongoing projects in different locations around the country. With such scale and size comes an opportunity to redefine oneself each day. Global partners like Armani, Dora, Noe Studios, UK, Disney & ACC are but a few of the coveted names in the list that the company boasts of today. Like the pre-cast technology setup, the company is fast diversifying while also supporting various causes like Raksha - an education initiative for the underprivileged.



**KEY HIGHLIGHTS**  
 Ongoing developments:  
 North city, Sector 74, Noida (GR), Sector 74, Noida (Sugamya), Sector 74, Noida (E-Square), Sector 74, Noida | The Ramana, Sector 118, Noida | Hill Town, Sector 2, Gurgaon | Sohna Road | Huma, Sector 48, Gurgaon & many more.  
 Landmarks Delivered:  
 34 Pavilion, Sector 34, Noida | Capswan, Sector 74, Noida | Eco Village II - Greater Noida (W) | Greater Noida (W) | EcoVillage, Sector 132, Noida Expressway | Supertech Emerald Court, Sector 79, A, Noida Expressway & many more.

Resale Plans approved by Uttar Pradesh State Home Dept. (DP - 1007 - JAN2001/2011/128 - State). (DP - 1007 - 2011) use plan 2010 for area taking within the residential plot area measuring 100 sqm. (DP - 1007 - 2011) use plan 2010/2011 in Sector 2, Gurgaon being approved by District - Bhiwani (DP - 1007 - 2011) use plan 1000 voluntary compliance of Supertech Ltd. (Dist. No. of Units in Group Housing 1330, Date of 2010) and 2011. (Transfer of the Project to the State, Transfer to the State, Complete Project and Release to the State).

\*Conditions apply. All buildings, information, specifications, etc. are tentative and subject to variation and modification by the company or its complete authorities sanctioning such plans. Images are for representative purposes only. \*To view the actual 3D/2D site, visit the site in real time. The shape of apartment may be seen in the floor.



DISCOVER THE *mystical* CHARM OF HILLS. AT HOME.

WELCOME TO

**HILL TOWN**  
 SECTOR 2, GURGAON-SOHNA ROAD

CAPTIVATING VIEWS. MESMERIZING LIFESTYLE.

